



www.harscorail.com

SERVICE BULLETIN

MAINTENANCE OF WAY EQUIPMENT

DATE: 8-2014

BULLETIN NO: 11-006A

TITLE: 5009757 Integral Spindle Replacement Kit

RATING:

<input checked="" type="checkbox"/>	DIRECTIVE (Action Is Required)	<input type="checkbox"/>	ALERT (Potential Problem)
<input type="checkbox"/>	INFORMATION (Action Is Optional)	<input type="checkbox"/>	PRODUCT IMPROVEMENT (Enhance Product)

PRODUCT SERIES / MODEL: HR1500 Series C1 HY-RAIL® Guide Wheel Unit

SERIAL NO: 60100 Through 60400

SUMMARY: It has come to the attention of Harsco Rail that the one inch hex head cap screw and hex nut that are located in the center of the integral spindles may have been over torqued. The over torquing may have occurred on any of the HR1500C1 HY-RAIL® Guide Wheel Units that have Serial Numbers 60100 through 60400. These units were shipped from the factory from April 8, 2011 through June 30, 2011. Because it is difficult to determine exactly which integral spindles may have the over torqued fastener, Harsco Rail has decided to replace all of the integral spindles on guide wheel units with the above listed serial numbers.

OPERATIONAL IMPACT: Over torquing of the one inch hex head cap screw and hex nut will cause the integral spindle to distort, causing the spindle bearings to overheat which will result in failure of the integral spindle. Integral spindle failure may result in the loss of the guide wheel.

ACTION: Check the serial number tag on your HR1500C1 guide wheel units for the above listed serial numbers. The units may be installed on your vehicle or in stock, waiting to be installed on a vehicle. If the unit is installed on a vehicle, spin each guide wheel by hand and check for any free play in the bearings. If the guide wheel does not spin freely or if there is free play in the bearings, the vehicle must be removed from service immediately and taken to an approved HY-RAIL® guide wheel equipment repair facility. A list of the approved HY-RAIL® repair facilities can be found at www.harscorail.com. The facility must replace the integral spindles before the vehicle can be returned to service. If the guide wheels spin freely and there is not play in the bearings, the vehicle may be used on rail only until the earliest convenient time when the vehicle can be taken to an approved HY-RAIL® guide wheel equipment repair facility to have the integral spindles replaced.

ACTION: If guide wheel units are in your stock, the integral spindles must be replaced before the unit is applied to a vehicle. In addition, Harsco Rail will replace any integral spindles that you received from April 8, 2011 through June 30, 2011 that are in your stock as repair parts. Use the contact information shown below to make arrangements for exchange.

The 5009757 Integral Spindle Replacement Kit includes the parts to rebuild one integral spindle assembly. Order two kits for each guide wheel unit. Use the contact information shown below to order the replacement kit.

Follow the instructions in this Service Bulletin to replace the integral spindles. Harsco Rail will pay a maximum labor rate of \$75.00 to replace each spindle. Harsco Rail must receive a completed copy of the attached form before credit for the labor will be issued. All replaced spindles must be returned to Harsco Rail. Use the contact information shown below to arrange labor credit and return shipping. After replacing the integral spindles on the guide wheel unit(s), make copies of the Integral Spindle Replacement Form, included with this Service Bulletin, and return it to Harsco Rail, using the address on the form.

CONTACT: HY-RAIL® Guide Wheel Equipment Parts Sales at (507) 235-7143.

Safety Information



- **FOLLOW APPLICABLE RAILROAD LOCKOUT - TAGOUT PROCEDURES TO DISABLE ENERGY SOURCES WHEN PERFORMING MAINTENANCE, MAKING ADJUSTMENTS OR REPAIRS TO THE VEHICLE OR EQUIPMENT. FAILURE TO HEED THIS WARNING COULD RESULT IN SEVERE BODILY INJURY.**

Integral Spindle Replacement

FIGURE 1
REMOVING / INSTALLING GUIDE WHEEL

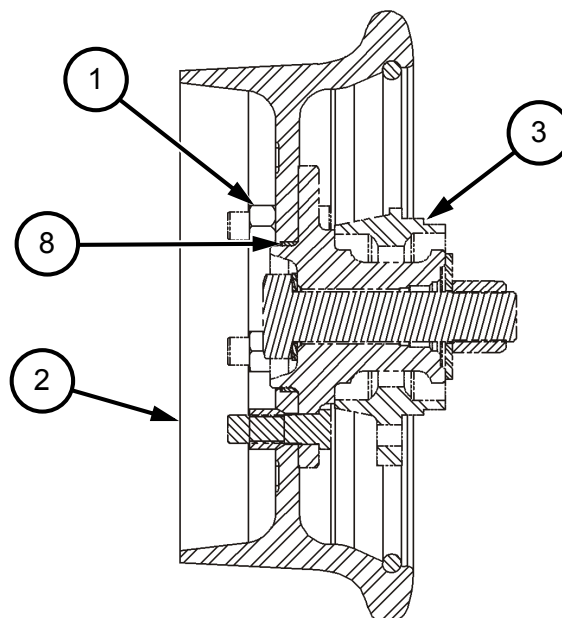

Integral Spindle Replacement - See Figures 1 and 2

1. Remove the five lug nuts (1), lug nuts and washers on rubber tread guide wheels, that secure the guide wheel (2) to the integral spindle (3). Remove the guide wheel from the integral spindle.
2. Remove three M12 socket head cap screws (4) being careful not to damage the insulating bushings inside the mounting holes. Discard the insulating washers (5), new insulating washers are included in the kit. Remove the integral spindle (3) being careful not to damage the insulating plate (6).
3. Install the new insulating washers (5) on the three M12 socket head cap screws (4). Make sure the M12 hardened washers (7) are in place between the cap screw socket head and the insulating washer.
4. The new integral spindle is provided completely assembled with the one inch hex nut and cap screw properly torqued. Apply Blue Loctite 242 to the threads on the three M12 socket head cap screws (4). Install the new integral spindle (3) and secure with three M12 socket head cap screws. Torque the M12 socket head cap screws to 60 lb-ft (81 N-m).
5. Remove the insulating bushing (8) from the pilot hole in the center of the guide wheel. Install the new insulating bushing (8) in the pilot hole of the guide wheel. Install the guide wheel being careful not to damage the insulating bushing (8). Secure with five lug nuts (1), lug nuts and washers on rubber tread guide wheels. Torque the lug nuts to 90 lb-ft (122 N-m).
6. After replacing both integral spindle assemblies on the guide wheel unit, record the guide wheel unit serial number on a copy of the attached Integral Spindle Replacement Form. Check the boxes to indicate that both integral spindles have been replaced. Mail the completed form to the address shown on the form.

FIGURE 2
SPINDLE ASSEMBLY

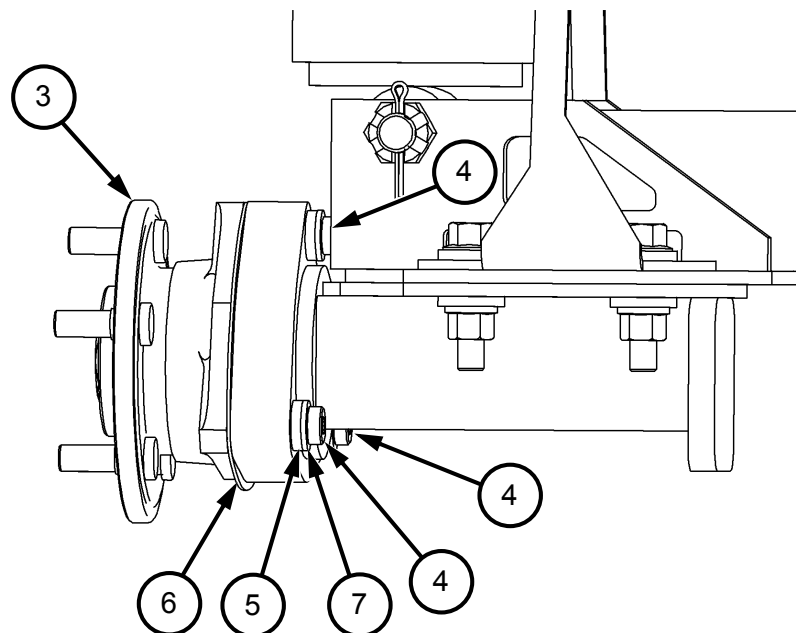

Integral Spindle Replacement Kit

PART NO	DESCRIPTION	QTY
5009757	INTEGRAL SPINDLE REPLACEMENT KIT.....	1
198689	Integral Spindle Assembly	1
3415867	Washer, 12 mm, Insulated	3
194007	Bushing, Insulated	1

© 2014 HARSCO CORPORATION, ALL RIGHTS RESERVED

415 North Main Street
Fairmont, MN
56031-1837
Tel: (507) 235-3361
Fax: (507) 235-7370

401 Edmund Road, Box 20
Cayce-West Columbia, SC
29171-0020
Tel: (803) 822-9160
Fax: (803) 822-7471

200 South Jackson Road
Ludington, MI
49431
Tel: (231) 843-3431
Fax: (231) 843-1644

Printed In USA

INTEGRAL SPINDLE REPLACEMENT FORM

When completed, mail this form to: **Harsco Rail**
415 North Main Street
Fairmont, MN 56031-1837
Attention: Julie Klages

Name of Trained Repair Facility: _____

HR1500C1 Guide Wheel Unit Serial Number: _____

Left Replaced Right Replaced

Completed By: _____ Date: _____

HR1500C1 Guide Wheel Unit Serial Number: _____

Left Replaced Right Replaced

Completed By: _____ Date: _____

HR1500C1 Guide Wheel Unit Serial Number: _____

Left Replaced Right Replaced

Completed By: _____ Date: _____

HR1500C1 Guide Wheel Unit Serial Number: _____

Left Replaced Right Replaced

Completed By: _____ Date: _____

HR1500C1 Guide Wheel Unit Serial Number: _____

Left Replaced Right Replaced

Completed By: _____ Date: _____

HR1500C1 Guide Wheel Unit Serial Number: _____

Left Replaced Right Replaced

Completed By: _____ Date: _____

HR1500C1 Guide Wheel Unit Serial Number: _____

Left Replaced Right Replaced

Completed By: _____ Date: _____

HR1500C1 Guide Wheel Unit Serial Number: _____

Left Replaced Right Replaced

Completed By: _____ Date: _____