



www.harscorail.com

---

## SERVICE BULLETIN

### MAINTENANCE OF WAY EQUIPMENT

---

**DATE:** 8-2014

**BULLETIN NO:** 14-007

**TITLE:** Integral Spindle Mounting Bolts

**RATING:**

<input type="checkbox"/>	<b>DIRECTIVE</b> (Action Is Required)	<input checked="" type="checkbox"/>	<b>ALERT</b> (Potential Problem)
<input type="checkbox"/>	<b>INFORMATION</b> (Action Is Optional)	<input type="checkbox"/>	<b>PRODUCT IMPROVEMENT</b> (Enhance Product)

**PRODUCT SERIES / MODEL:** HR1500 Series B2, HR1500 Series B3 and HR1500 Series C1  
HY-RAIL® Guide Wheel Units

**SERIAL NO:** N/A

**SUMMARY:** Harsco Rail has become aware of a possible issue caused by improper repair procedures when integral spindles are replaced on HR1500 guide wheel units. On affected guide wheel units, the integral spindle mounting bolts could become loose and / or break. Harsco Rail is requesting that you take action on any of your vehicles that have had the integral spindle removed and replaced between January 2013 and July 2014. If your vehicle is affected, the spindle mounting bolts must be removed and re-installed using the proper repair procedure. The affected vehicle must be removed from service and taken to an approved HY-RAIL® guide wheel equipment repair facility.

**OPERATIONAL IMPACT:** Integral spindle mounting bolts could become loose and / or break if improper repair procedures are used when the integral spindle is replaced on the guide wheel unit. Failure of the integral spindle mounting bolts may result in the loss of the guide wheel.

**ACTION:** The affected vehicle must be removed from service and taken to an approved HY-RAIL® guide wheel equipment repair facility. A list of the approved HY-RAIL® repair facilities can be found at [www.harscorail.com](http://www.harscorail.com). Follow the instructions in this Service Bulletin to disassemble and re-assemble the integral spindle on the guide wheel unit. The vehicle may be returned to service once the procedure is completed and the guide wheel equipment has been re-aligned. Always make sure to do a complete walk around inspection of the vehicle and guide wheel equipment daily.

**CONTACT:** HY-RAIL® Parts Sales: (507) 235-7143  
HY-RAIL® Service: (507) 235-7212 or (507) 235-713

**Safety Information**

- **FOLLOW APPLICABLE RAILROAD LOCKOUT - TAGOUT PROCEDURES TO DISABLE ENERGY SOURCES WHEN PERFORMING MAINTENANCE, MAKING ADJUSTMENTS OR REPAIRS TO THE VEHICLE OR EQUIPMENT. FAILURE TO HEED THIS WARNING COULD RESULT IN SEVERE BODILY INJURY.**

**Integral Spindle Re-work - See Figures 1 and 2**

1. Make sure the vehicle transmission is in PARK or NEUTRAL and the parking brakes are applied. Stop the vehicle engine. Lock-out / Tag-out vehicle ignition switch.
2. To be able to remove and re-install the three M12 socket head cap screws (1) properly, the stub axle (2) will need to be removed from the guide wheel unit.
3. Remove the four 1/2"-20 disc lock nuts, washers and hex head cap screws (3) to remove the stub axle (2). Place the stub axle in a vice to hold it securely.
4. Remove the three M12 socket head cap screws, washers and insulating washers (1) being careful not to damage the insulating bushings inside the mounting holes. Remove integral spindle (4) from stub axle (2).
5. Clean the threaded holes in the integral spindle and the threads on the three M12 socket head cap screws.
6. Inspect all insulating washers and bushings. If any are found that are damaged, replace them.
7. Apply Blue Loctite 242 to the threads on the three M12 socket head cap screws (1). Install the integral spindle on the stub axle.
8. Secure the integral spindle to the stub axle with the three M12 socket head cap screws. Make sure the M12 hardened washers and insulating washer are properly in place between the M12 socket head cap screws and the flange on the stub axle. Torque the M12 socket head cap screws (1) to 60 lb-ft (81 N-m).
9. Assemble the stub axle and axle strap (5) (if present) to the guide wheel unit using the four 1/2"-20 disc lock nuts, washers and hex head cap screws (3). Position the stub axle as close as possible to its original position when it was removed.
10. Torque the four 1/2"-20 disc lock nuts to 110 lb-ft (149 N-m).
11. Re-align the guide wheel equipment on the vehicle before returning the vehicle to service.

**Integral Spindle Re-work**

FIGURE 1  
INTEGRAL SPINDLE AND STUB AXLE ASSEMBLY

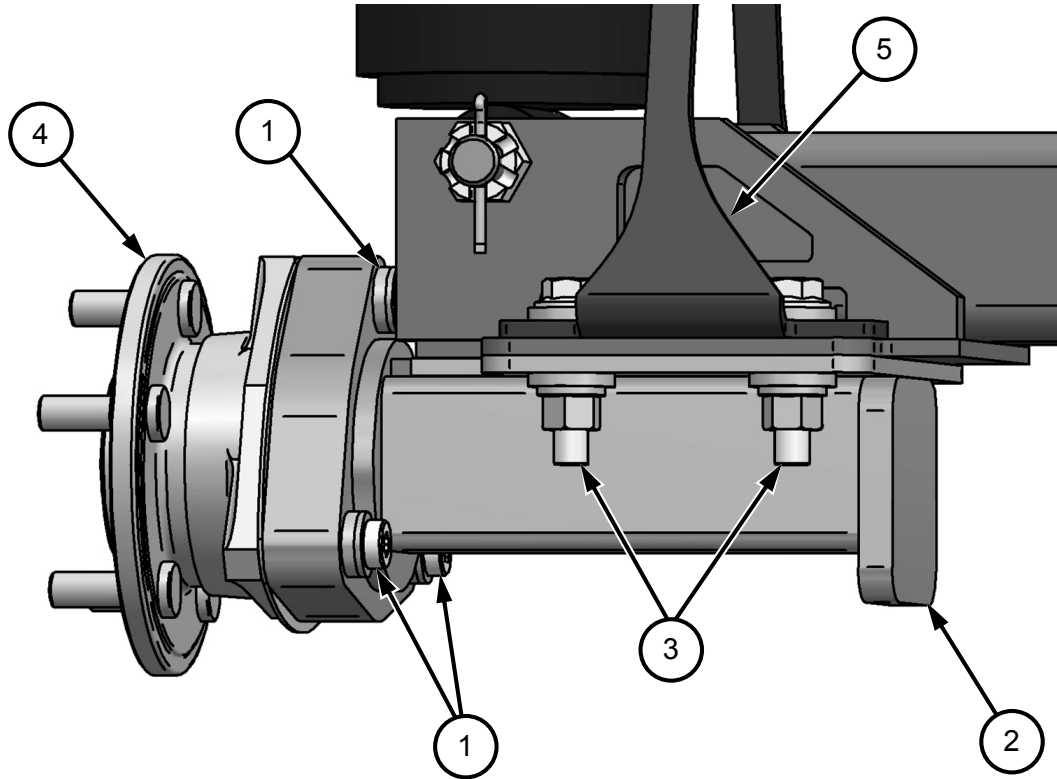
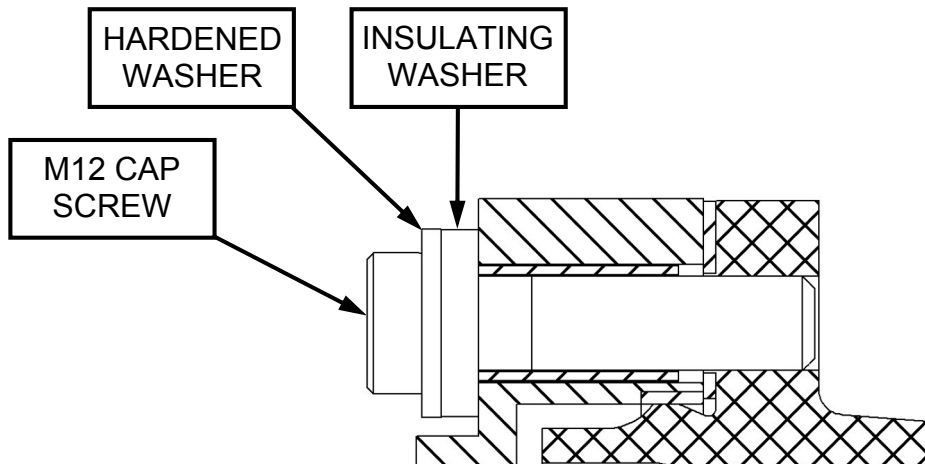

FIGURE 2  
M12 CAP SCREW, HARDENED WASHER  
AND INSULATING WASHER ASSEMBLY DETAIL



**© 2014 HARSCO CORPORATION, ALL RIGHTS RESERVED**

415 North Main Street  
Fairmont, MN  
56031-1837  
Tel: (507) 235-3361  
Fax: (507) 235-7370

401 Edmund Road, Box 20  
Cayce-West Columbia, SC  
29171-0020  
Tel: (803) 822-9160  
Fax: (803) 822-7471

200 South Jackson Road  
Ludington, MI  
49431  
Tel: (231) 843-3431  
Fax: (231) 843-1644

Printed In USA