



Harsco Track Technologies

Harsco

www.harscotrack.com

SERVICE BULLETIN MAINTENANCE OF WAY EQUIPMENT

DATE: 10-18-2001 **BULLETIN NO:** 01-014

TITLE: 198194 AXLE WASHER REPLACEMENT SERVICE GROUP

RATING:

| | | | |
|--------------------------|--|-------------------------------------|---|
| <input type="checkbox"/> | DIRECTIVE (Action Is Required) | <input checked="" type="checkbox"/> | ALERT (Potential Problem) |
| <input type="checkbox"/> | INFORMATION (Action Is Optional) | <input type="checkbox"/> | PRODUCT IMPROVEMENT (Enhance Product) |

PRODUCT SERIES / MODEL: All Vehicles Equipped With HY-RAIL® Guide Wheel Equipment Series HR18, HR2000A and HR2000B

SERIAL NO: All Models HR18, HR2000A and HR2000B

SUMMARY: The 3/32 inch thick axle washer can deform due to excess rail wheel flanging loads and cause excessive play in the rail wheel assembly. The 3/32 inch axle washer must be replaced by a 3/16 inch thick axle washer.

OPERATIONAL IMPACT: To extend the rail wheel bearings and rail wheel life.

ACTION: Inspection and/or replacement of the axle washer requires:

- Disassembly of the rail wheel to inspect and measure the existing axle washer thickness.
- If the existing axle washer thickness is 3/32 inch (2.38 mm), the axle washer must be replaced.
- If the existing axle washer thickness is 3/16 inch (4.76 mm), the axle washer can be re-used provided it is not deformed.
- Re-assembly of the rail wheel.
- Re-torquing of the spindle nut.

CONTACT: To order replacement axle washers, please contact the HY-RAIL® Parts Department at the Fairmont, MN. facility, (507) 235-7143.

SAFETY INFORMATION



- **FOLLOW APPLICABLE RAILROAD LOCKOUT - TAGOUT PROCEDURE TO REMOVE ALL ENERGY SOURCES FROM VEHICLE AND RAIL GUIDE WHEEL EQUIPMENT. FAILURE TO COMPLY COULD RESULT IN SEVERE BODILY INJURY.**

AXLE WASHER INSPECTION AND/OR REPLACEMENT - See Figure 1

1. Remove the hub cap from the wheel hub. Remove the cotter pin and then remove the castle nut from the spindle. Remove the existing axle washer from the spindle.
 - 2.1 If the thickness is 3/32 inch (2.38 mm), the axle washer must be replaced.
 - 2.2 If the thickness is 3/16 inch (4.76 mm), the axle washer can be re-used provided it is not deformed.
3. Install the axle washer (1) on the spindle. Install the castle nut on the spindle and torque to 20 ft-lbs. Loosen the castle nut and re-torque to 7 ft-lbs. Then back off the castle nut 1/2 to 1 flat and secure with the cotter pin (2). Install the hub cap on the wheel hub.

FIGURE 1 SE01A354A-1
RAIL WHEEL ASSEMBLY

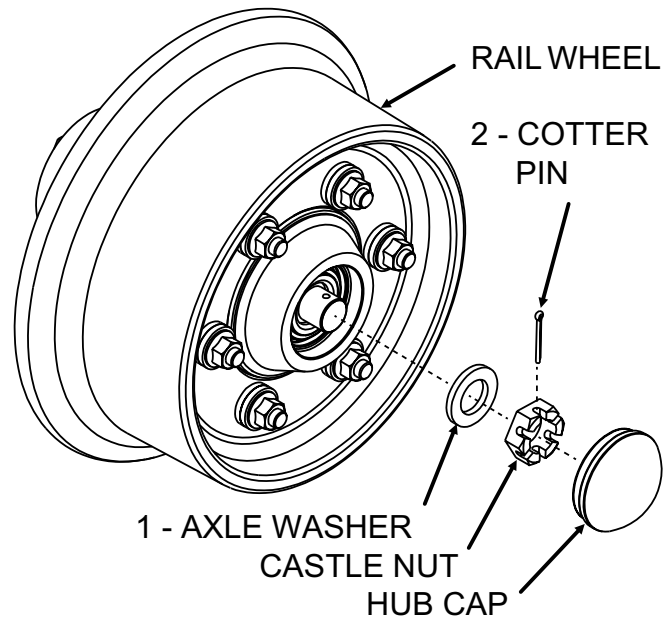

AXLE WASHER REPLACEMENT PARTS LIST - See Figure 1

| ITEM | PART NO | DESCRIPTION | QTY |
|------|---------|--|-----|
| | 198194 | AXLE WASHER REPLACEMENT SERVICE GROUP. | 1 |
| 1 | F008727 | Axle Washer, 3/16" Thick | 2 |
| 2 | F001182 | Cotter Pin, 1/8" x 1-1/4". | 2 |

© 2001 HARSCO TRACK TECHNOLOGIES, HARSCO CORPORATION

415 North Main Street
Fairmont, MN
56031-1837
Tel: (507) 235-3361
Fax: (507) 235-7370

2401 Edmund Road, Box 20
Cayce-West Columbia, SC
29171-0020
Tel: (803) 822-9160
Fax: (803) 822-7471

200 South Jackson Road
Ludington, MI
49431
Tel: (231) 843-3431
Fax: (231) 843-4830