

---

## SERVICE BULLETIN

### MAINTENANCE OF WAY EQUIPMENT

---

**DATE:** 07 - 2025

**BULLETIN NO:** SBU000130-25

**TITLE:** INSTALLATION OF THE DIVERSION HOSE ABOVE THE HANDBRAKE BASE.

**RATING:**

☐

**DIRECTIVE**

(Action Is Required)

☐

**ALERT**

(Potential Problem)

☐

**INFORMATION**

(Action Is Optional)

☒

**PRODUCT IMPROVEMENT**

(Enhance Product)

**PRODUCT SERIES / MODEL:** NYCT R252 series flat cars

**SERIAL NO:** OF801-OF944

**SUMMARY:** Harsco Rail is offering a procedure to install a hose to the end board stake pocket to prevent the debris falling on to the Hand brake.

**OPERATIONAL IMPACT:** Installation of this hose prevents the debris falling on to the hand brake.

**ACTION:** Harsco Rail P/N 5151495 and P/N 052526211 for each machine being installed. Follow the instructions in this Service Bulletin to install the Hose onto the end board stake pocket of Flat cars.

**CONTACT:** Harsco Rail Service Department  
(803) 822-7546  
Harsco Rail Parts Department  
(800) 800-6410

#### SAFETY INFORMATION



- Follow applicable railroad lockout - tagout procedure to remove machine from energy source. Failure to comply could result in severe bodily injury.

## **Installation of Diversion Hose:**

### **Tools Required:**

1. 5/16" socket, extension (as required) and ratchet.
2. Soapy water for lubrication.
3. Cutting tool.

### **Materials Required:**

1. 12" Hose P/N 5151496.
2. Hose clamp P/N 052526211.

### **Preparation for the Installation:**

1. Make sure all machine work components are in the stored position and locks are engaged.
2. Make sure parking brakes are applied, and chock the machine wheels.



- Do not use oil to lubricate the end board stake pocket, use only soap water.
- Wear Personal Protective Equipment like protective clothing, sturdy footwear & cut resistant gloves while cutting the hose and maintain hand positioning away from the cutting path.

**Diversion Hose Installation:**

1. At hand brake end, hand brake side, locate the end board stake pocket (square tube) just above the handbrake base (Not shown for clarity).

**FIGURE 1: END BOARD STAKE POCKET**

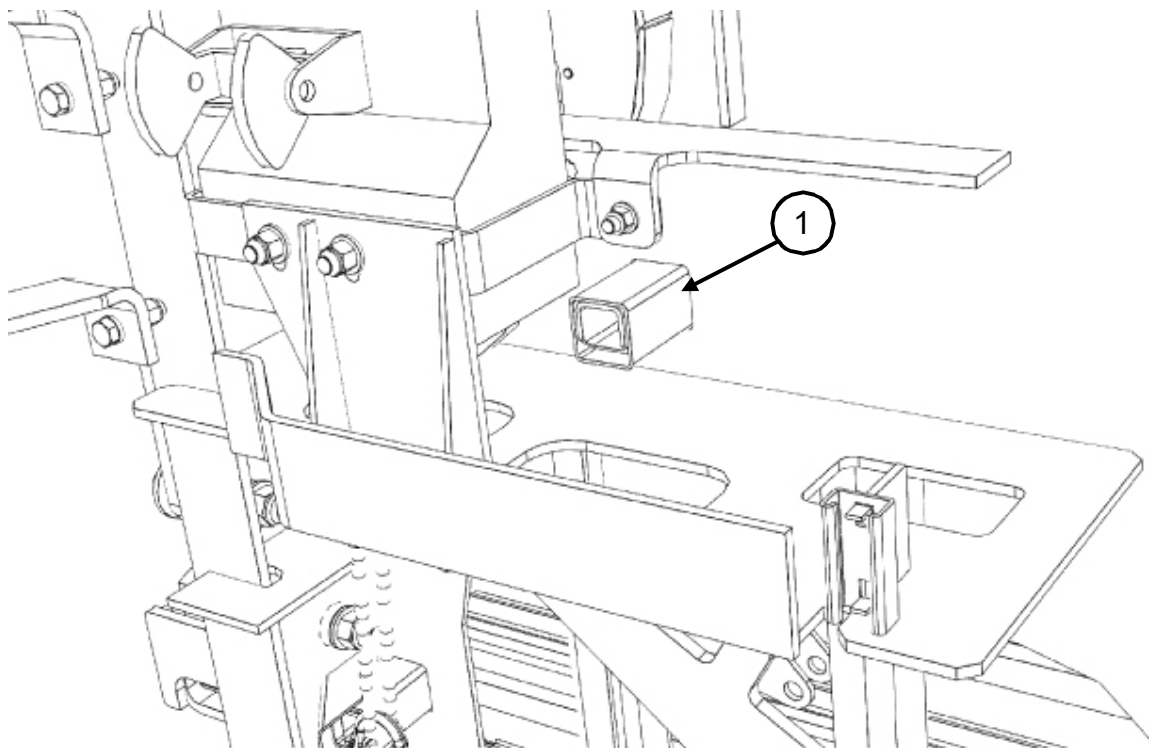

2. Lubricate the end board stake pocket (1) and hose with soapy water, do not use oil.
3. Slide the hose (2) over the stake pocket up to the bottom of the upper deck main frame plate.
4. Slide the hose clamp (3) over the hose to approximately the halfway point of the end board stake pocket.
5. Using the socket, ratchet and extension (as needed), secure the clamp and hose tight to the end board stake pocket.
6. Use the cutting tool, cut approximately a 45° angle on one end. Orientated so that the cut portion of the hose is down and towards the longitudinal C/L of the car (See Figure 3).
  - a. Cutting the hose after installation prevents having to rotate the hose on the end board stake pocket.

**FIGURE 2: DIVERSION HOSE INSTALLATION**

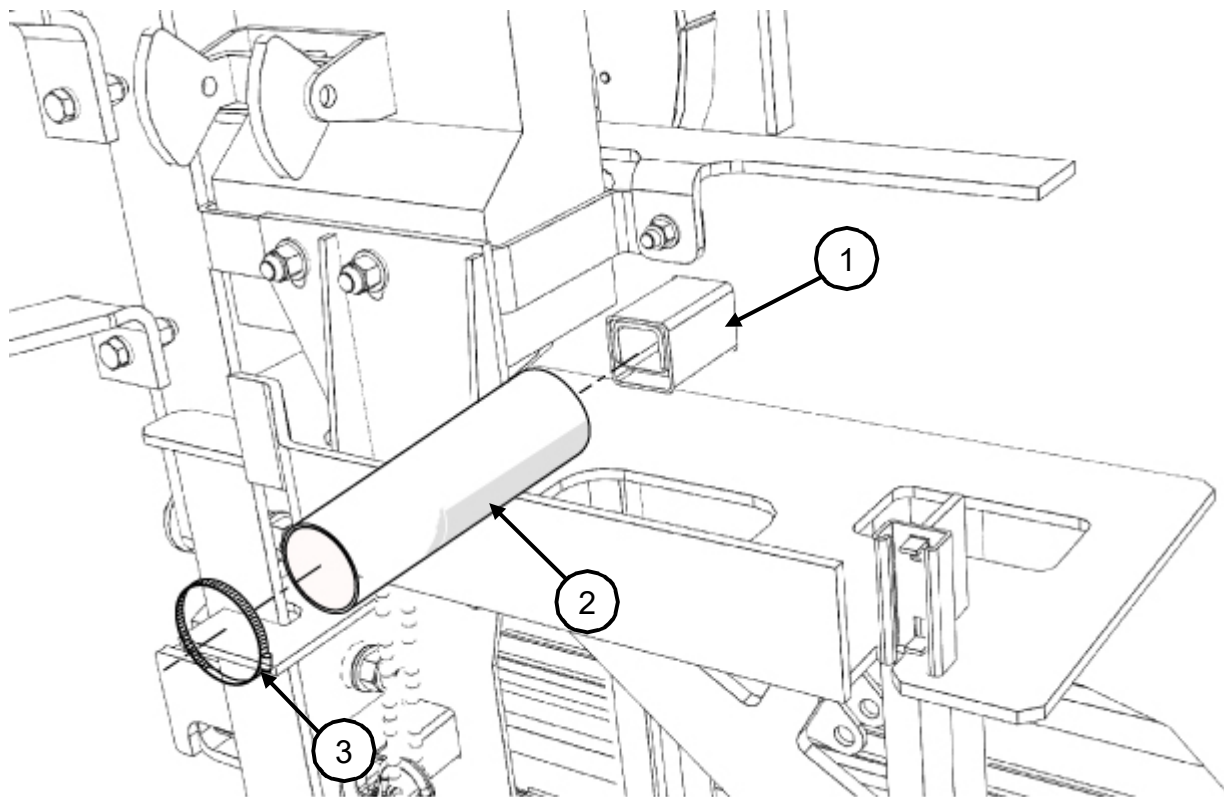

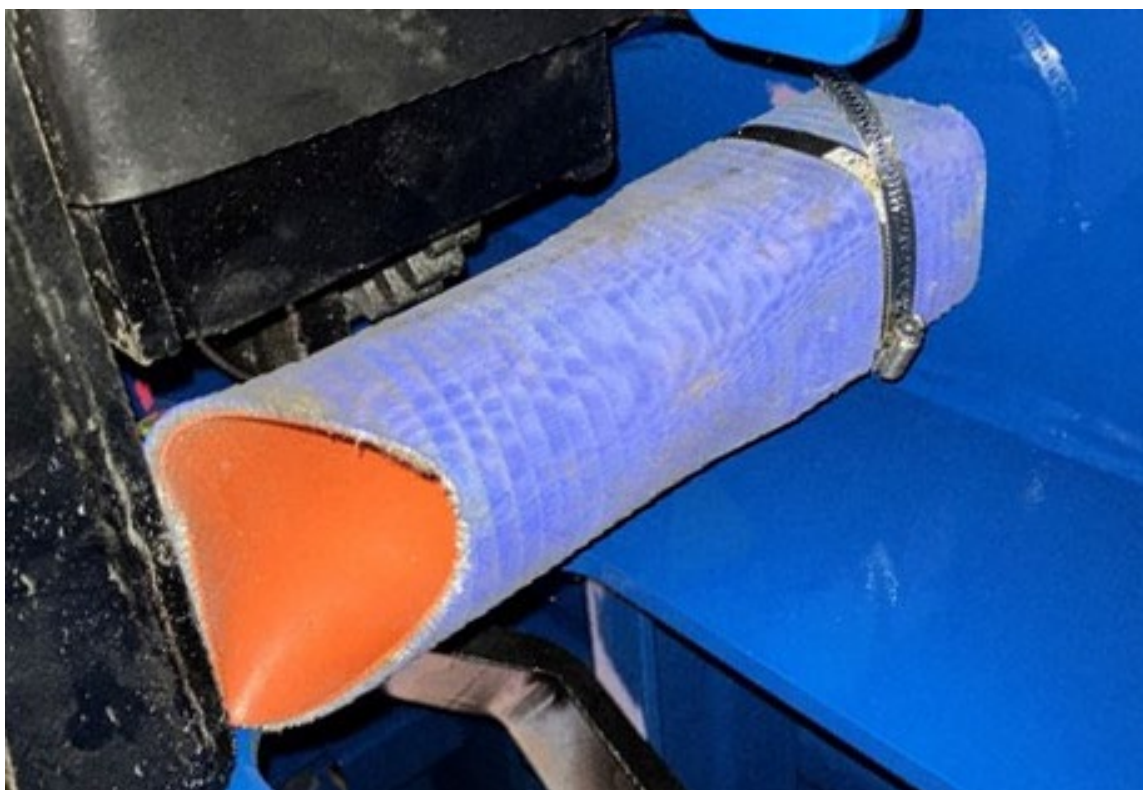
**FIGURE 3: DIVERSION HOSE INSTALLED**

*Note: The images shown are for reference only.*

**© 2025 HARSCO RAIL, LLC, HARSCO CORPORATION**

306 West 4th Street  
Fairmont, MN  
56031-1837  
Tel: (507) 235-7376  
Parts: (800) 800-6410  
Fax: (507) 235-7372

2401 Edmund Road, Box 20  
Cayce-West Columbia, SC  
29171-0020  
Tel: (803) 822-7420  
Parts: (800) 800-6410  
Fax: (803) 822-7403

200 Conrad Industrial Dr.  
Ludington, MI  
49431  
Tel: (231) 843-3431  
Parts: (800) 800-6410  
Fax: (231) 843-1644

Printed in U.S.A.