



[www.harscorail.com](http://www.harscorail.com)

---

## SERVICE BULLETIN

### MAINTENANCE OF WAY EQUIPMENT

---

**DATE:** 12-18-2025

**BULLETIN NO:** SBUS000138-25

**TITLE:** Tow Circuit Update – TX16 Tamper

**RATING:**

☐

**DIRECTIVE**

(Action Is Required)

☒

**ALERT**

(Potential Problem)

☐

**INFORMATION**

(Action Is Optional)

☐

**PRODUCT IMPROVEMENT**

(Enhance Product)

**PRODUCT SERIES / MODEL:** TX16 Tamper

**SERIAL NO:** 7420018, 7420020, 7420030, 7420041, 7420052, 7420062, 7420073,  
7420083, 7420093, 7420103, 7420113

#### SUMMARY:

This document details steps to take to prevent machine movement resulting from an unintentional parking (spring) brake release. The process involves applying decals to the machine outlining the towing procedure and updating the tow circuit plumbing to reduce unintended machine movement risk.

#### OPERATIONAL IMPACT:

As currently designed, TX16 has potential to roll away on grade while axle gearboxes are in neutral due to unintentional parking brake release for either of the two scenarios listed below:

- 1) After pressurization of the emergency brake release and decoupling TX16 from the towing vehicle, air was not properly vented from the tow circuit and spring brake control circuit.
- 2) Tow circuit brake supply pressurization check valve (check valve #3) has failed open and is allowing the main reservoir to pressurize the spring brake control circuit.

#### CONTACT:

Harsco Rail Service Department

Please contact:

David Thomas - [dthomas@harsco.com](mailto:dthomas@harsco.com) – phone (803)509-1717

Kelly Gardner - [kgardner@harsco.com](mailto:kgardner@harsco.com)

**SAFETY INFORMATION**

- Follow applicable railroad lockout - tagout procedure to remove machine from energy source. Failure to comply could result in severe bodily injury.

FIGURE 1  
REAR EMERGENCY BRAKE RELEASE PORT



FIGURE 2  
FRONT EMERGENCY BRAKE RELEASE PORT



**ACTION:**

- 1) Post Towing Procedure - Before decoupling of the tow bar between TX16 and the towing vehicle, it is necessary to vent trapped air in the tow circuit to ensure parking brakes are re-applied. This is accomplished by CLOSING the vented ball valve at the tow port by turning the handle perpendicular to the valve body. See Figures 1 and 2. Follow the procedure on the new decal 5153131.
- 2) Verification of Parking Brake Application - In the event of a Check Valve #3 failure, main reservoir pressure will apply pressure to the spring brake control circuit and release the parking brakes.  
To ensure parking brakes are functioning, it is important to monitor the parking brake icon on the Jupiter main control screen. This icon will illuminate yellow if a pressure of 60 psi or below is sensed in the spring brake control circuit (75 psi is required to release the parking brakes) and will inform the operator that the parking brake is applied. It is especially important during machine startup to remain in the operator seat until air system pressure has reached 75 psi or greater and check that the parking brake is still applied.



- 3) Replacement of Emergency Brake Release Port Quick Disconnect Fitting - To ensure venting of the tow circuit in any valve position, replace the quick disconnect socket (female) fitting with a plug (male) fitting. Fitting part number is F009771 and two are supplied. Replace both front and rear fittings.

FIGURE 3  
REPLACE QUICK-DISCONNECT FITTINGS

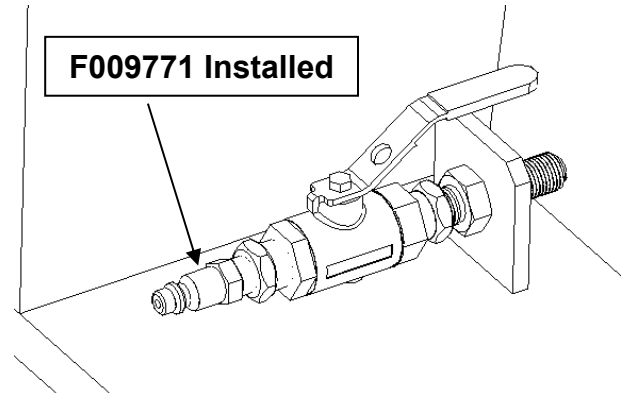
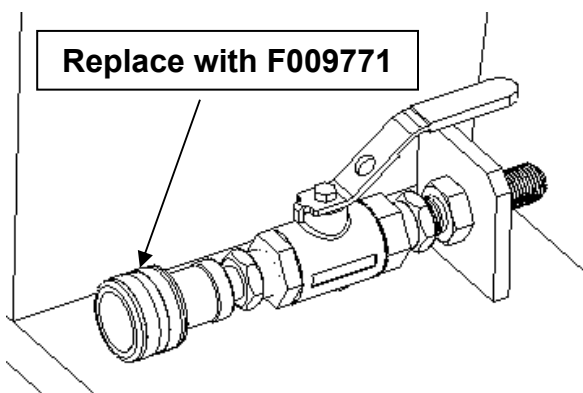

- 4) Apply Towing Procedure Decals - Affix towing procedure decal part number 5153131 to the front and rear of the machine in the area indicated below. Clean the area before application. See Figure 4.

FIGURE 4  
APPLY NEW EXTERIOR DECALS

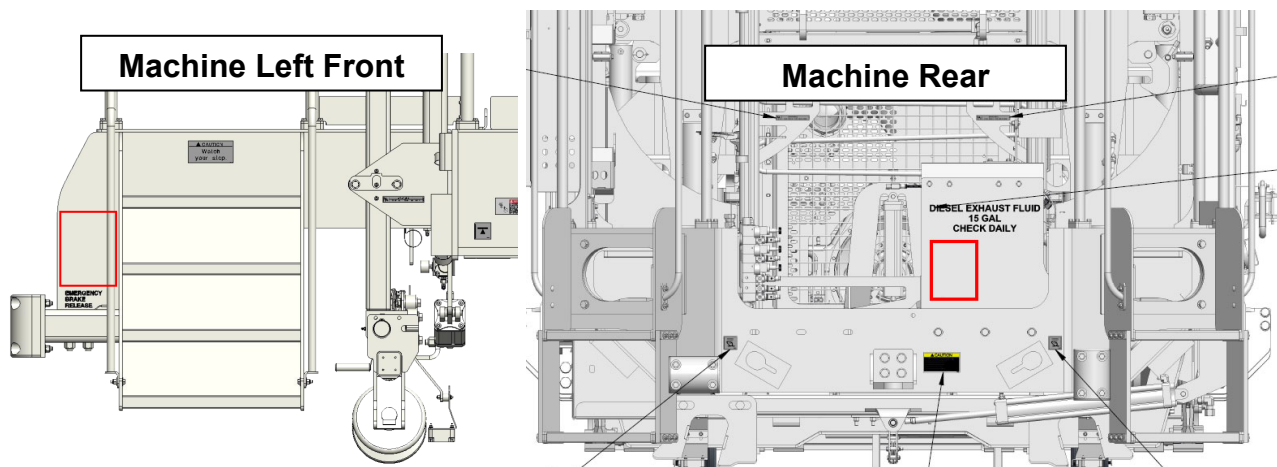

- 5) Replace Operations Guide Decal - Further clarification of towing procedure is needed on the operation guide in the cab. Replace the existing decal with the updated decal, part number 5142499, revision B. See Figure 5.

FIGURE 5  
REPLACE NEW INTERIOR DECALS

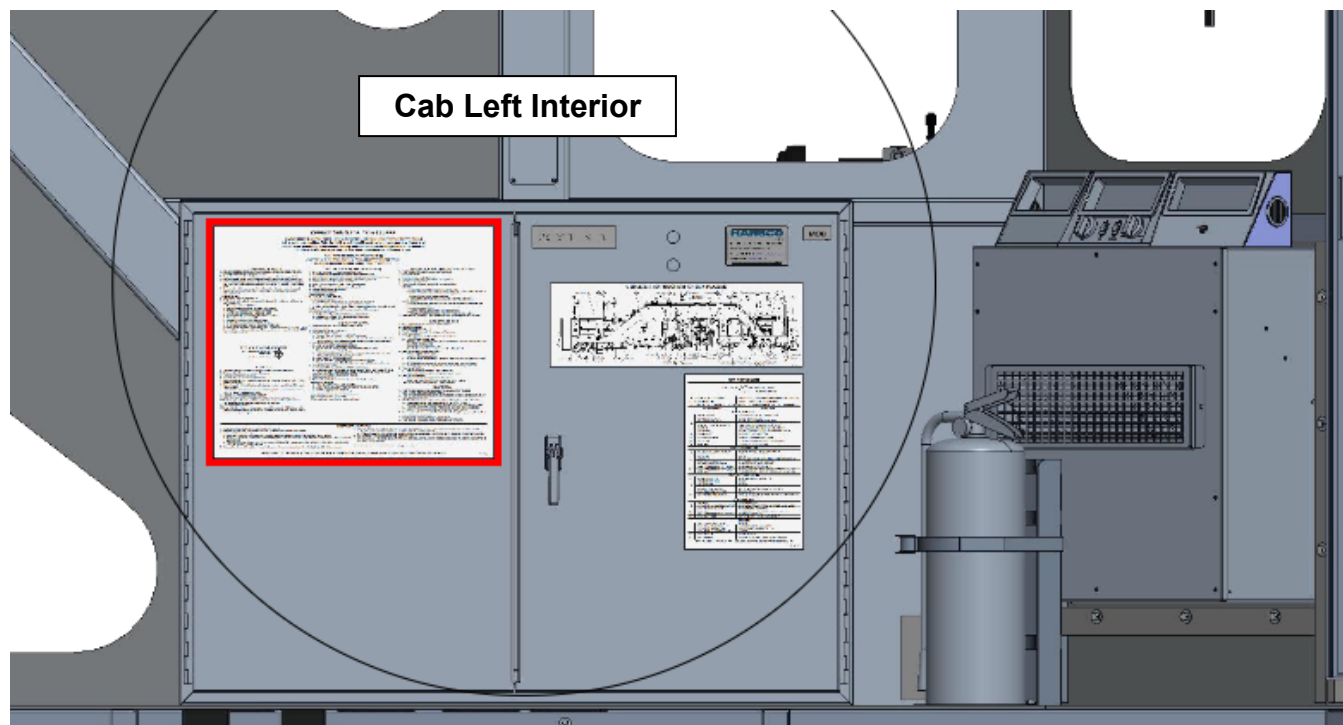

**In the event of an unintentional parking brake release:**

Attempt to slow the machine with the service brakes by pulling the left joystick toward you. If this does not slow the machine, turn off the Jupiter control system by pulling up on the Interlock Switch (3) located on the right-side console. This will force full application of the service brakes. Immediately after the machine has come to a stop, chock the wheels to prevent machine movement and inspect the spring brake control and brake supply circuits for damage or leaks. If check valve #3 has failed, there will be air leaking from the vent on either the front or rear tow port ball valve. See Figure 6.

FIGURE 6  
INTERLOCK SWITCH – RH SIDE CONSOLE

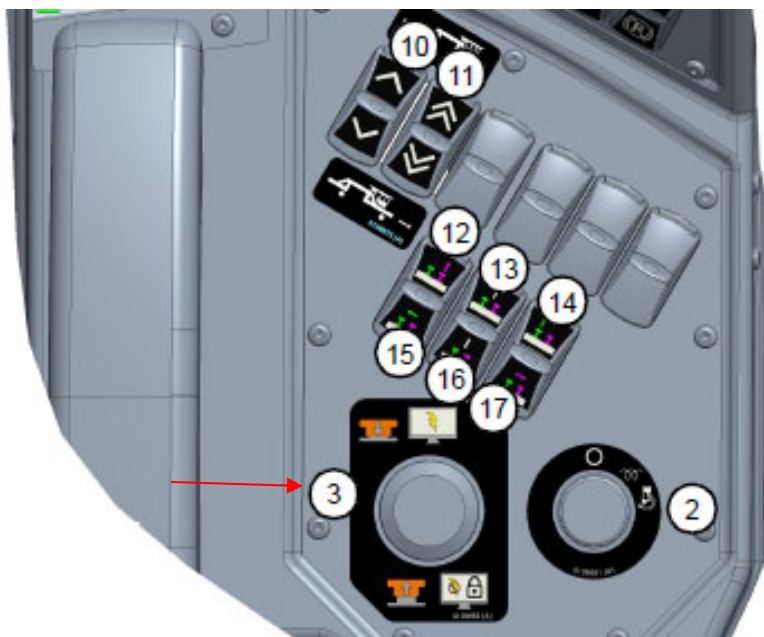
**Service Parts List**

ITEM	PART NO.	DESCRIPTION	QTY
1	5153131	DECAL, TOWING PROCEDURE	2
2	5142499	DECAL, OPERATIONS GUIDE	1
3	F009771	COUPLING PLUG	2

**FACILITY LOCATIONS****HARSCO RAIL, LLC**

306 West Fourth Street  
Fairmont, MN  
56031-1837  
Tel: +1 (507) 235-7376  
Parts: +1 (800) 800-6410  
Fax: +1 (507) 235-7372

**HARSCO RAIL, LLC**

2401 Edmund Road, Box 20  
Cayce-West Columbia, SC  
29171-0020  
Tel: +1 (803) 822-7420  
Parts: +1 (800) 800-6410  
Fax: +1 (803) 822-7403

**HARSCO RAIL, LLC**

200 South Jackson Road  
Ludington, MI  
49431  
Tel: +1 (231) 843-3431  
Parts: +1 (800) 800-6410  
Fax: +1 (231) 843-1644

**HARSCO RAIL  
GLOBAL HEADQUARTERS**

3440 Toringdon Way  
Suite 107, Building 3  
Charlotte, NC 28277  
56031-1837  
Tel: +1 (980) 960-2624

**HARSCO RAIL, LTDA**

Av. Marechal Câmara  
160 / 1615, Centro  
Rio de Janeiro RJ 20020-080  
Brazil  
Tel: +55 21 2510-5164 / -  
5151

**HARSCO RAIL EUROPE,  
GmbH**

Luetticher Str. 130  
40547 Duesseldorf, Germany  
Tel: +49 (0) 211 60116 0

**HARSCO RAIL CHINA**

Room C1201 Tower 2,  
No.36 BeiSanHuan Dong Lu,  
DongCheng District,  
Beijing 100013, P.R. China  
Phone: +87 10-6590-6399

**HARSCO TRACK  
MACHINES AND  
SERVICES PRIVATE**

Limited India  
2nd Floor, Building Alpha,  
Bengal Intelligent Park Block  
EP & GP,  
Sector V, Salt Lake, Kolkata  
700091 West Bengal, India  
Phone: +91 33 2357 5651

**HARSCO RAIL MALAYSIA**

3-5, Block A, Jaya One  
72A Jalan Profesor Diraja  
Ungku Aziz,  
46200 Petaling Jaya,  
Selangor, Malaysia

**HARSCO RAIL LTD**

Unit 1 Chewton Street  
Eastwood, Nottingham, NG16  
3HB  
United Kingdom  
Tel: +44 (0) 1773 539480

**HARSCO RAIL PTY LTD**

157 Granite St  
Geebung, Queensland 4034  
Australia  
Tel: 61 7 3205 6500  
Fax: 61 7 3205 7369

© 2025 HARSCO RAIL, LLC, ALL RIGHTS RESERVED

Printed In USA